

# Plan 3A

## 3 Bed + 2 Bath + Flex

GRYPHON  
**NOVA**

GRYPHON  
**nest**

INTERIOR SPACE: 1,092 SQFT  
EXTERIOR SPACE: 107 SQFT  
TOTAL SPACE: 1,199 SQFT

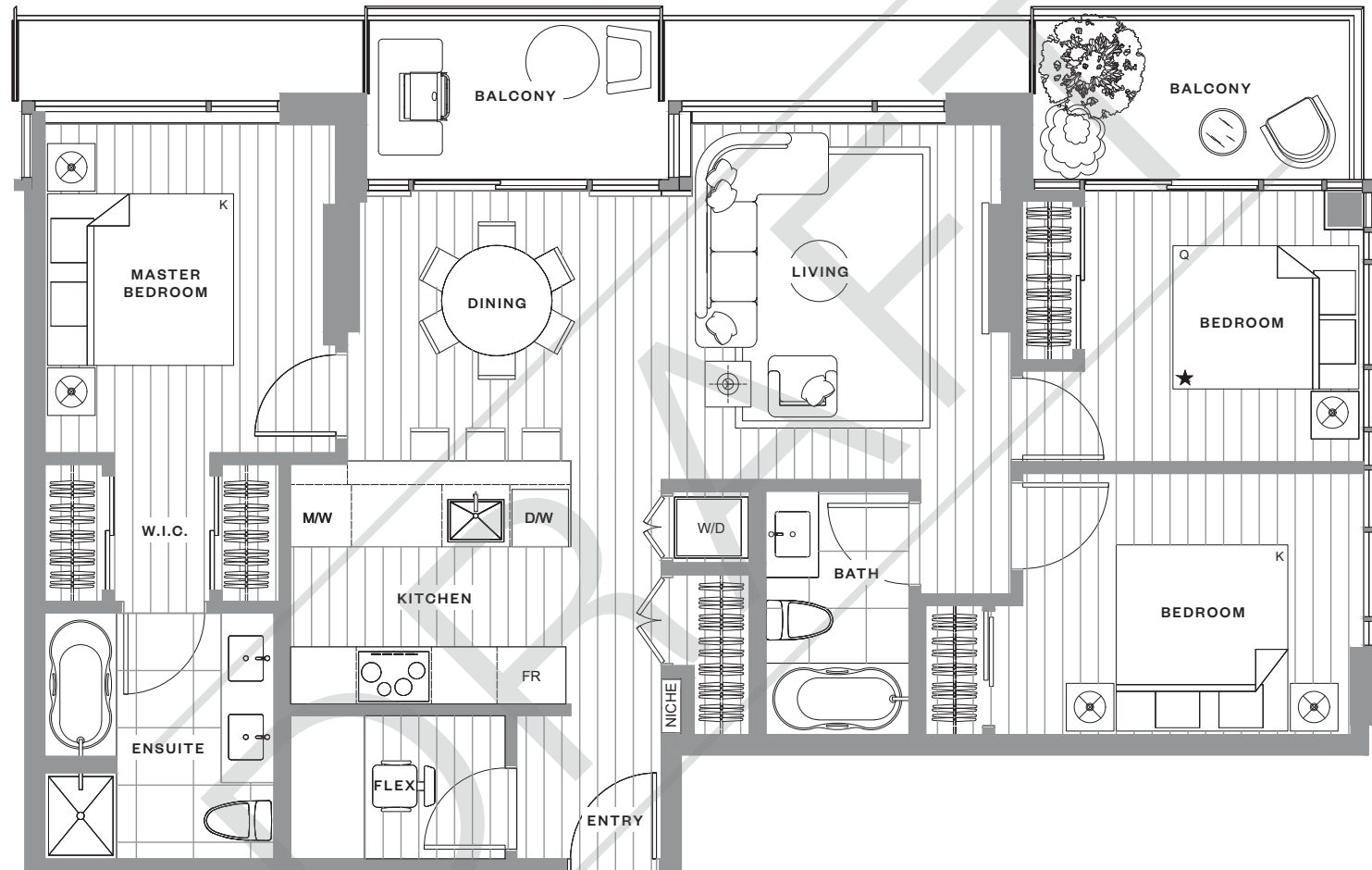

## Bigger Space, Brighter Future

Gryphon Nova embodies the integration of art and living. Enjoy unparalleled flexibility when it comes to making use of your space, with furniture that recedes on command when you don't need it.

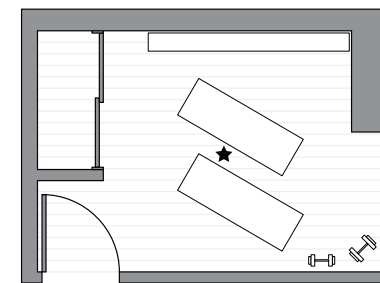

### Morning

Making space more efficient with a bed, desk and storage that disappears into the ceiling. Create space for whatever moves you.

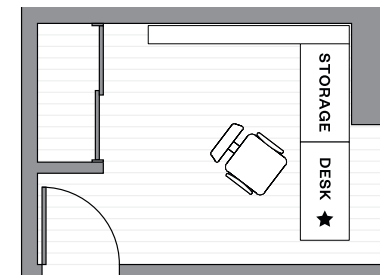

### In the Afternoon

Home office space with a 52" ceiling desk, magnetically stabilized for sitting or standing.

Intelligent storage unit with image capturing function for easy store and search.

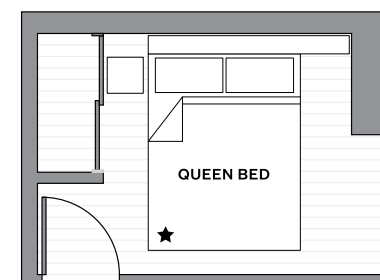

### At Night

Space for a restful night. Lower your bed, dim the built in lights and turn the space into your night time sanctuary.

### SMART HOME FEATURES

- Custom entry niche with UV sanitizing drawer and wireless charging pad
- Integrated smart home system for lighting and temperature control
- In-home air and water filtration for your health
- Triple-pane exterior window maximize energy efficiency and acoustic control

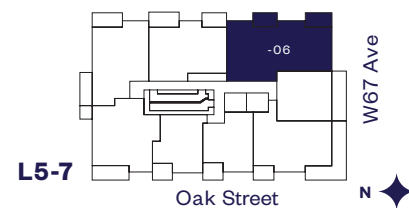

This is not an offer for sale and is for information purposes only. An offer for sale may only be made in conjunction with a Disclosure Statement. E. & O.E. The above images or drawings are for illustration purposes only. The developer reserves the right to alter size, price, design and/or finishings at any time.